

E Class Controllers

The New Wave in Residential Irrigation Control

E Class controllers offer powerful, flexible irrigation control for any residential landscape. Three independent programs provide for diverse irrigation requirements including lawns, shrubs, and drip irrigation systems. With a “no-fuse” diagnostic circuit breaker and a “no-battery” 24 hour memory and time backup, the E Class is virtually maintenance free. The E Class is also loaded with features that make an attractive, professional installation fast and easy. With Rain Bird reliability and ease of programming, the E Class will provide years of worry-free operation.

Features

- Three programs (A, B and C), each completely independent, allow mixed irrigation applications
- 365-day calendar for ODD or EVEN day watering or ODD-with-31st-of-the-month-off selection per program (adjusts for leap year)
- Repeating day cycles, allow irrigation every 1, 2, 3, 4-days, etc. up through 7. (In the 7-day weekly cycle any day can be set ON or OFF as a watering day.)
- Day Cycles are selectable per program.
- Diagnostic circuit breaker without a fuse identifies a station with valve or wire fault and continues to water operable station
- Test Program (1-10 minute all stations) for system operational testing
- Water Budget, selectable for each program, for seasonal adjustments
- Electrical surge protection (input and output) for reliability
- Rain sensor or moisture sensor hookups with override switch
- Easy-to-install cabinet includes a mounting bracket and (for outdoor models) an electrical junction box
- 24 hours of memory and time protection, in case of power outage (no battery required)
- Operating modes: Fully automatic, manual single station, manual multiple station or group, manual program start, all-stations-test mode and controller OFF
- Selectable a.m./p.m. or 24-hour-format time display mode

- Default program in case a power outage outlasts the memory protection (The default program automatically clears itself when the controller is reprogrammed.)
- Manual “clear” function allows manual erasure of all programs
- Start time stacking prevents overlap of programs in operation
- Any station can be assigned to any or all programs
- Remote-ready connector. Compatible with Rain Bird's RMX multi-function remote control system.

Operating Specifications

- Programming schedule options: ODD day/date watering (per program), EVEN day/date watering (per program), 1 through 7-day repeating cycle (per program), 7-day weekly cycle with any day ON or OFF setting, and ODD less 31st day of the month watering.
- Station Timing: 0 to 240 minutes in 1-minute increments
- Automatic starts per water day: 18 start times (6 per program per day)
- Water Budgeting: 0%-200% in 10% increments selectable by program (0% = individual program OFF)

Electrical Specifications

- Input required: 117 VAC ± 10%, 60 Hz (230 VAC international models available)
- Output 24 VAC @ 0.65A
- Valve capacity: One 24 VAC solenoid valve per station plus a master valve
- Terminal strip capacity: accepts #20, #18, or #16 AWG (0,813 mm, 1,22 mm, or 1,63 mm) size valve wire
- Two SENSOR terminals provide for attachment of a rain or an underground moisture sensor system. A SENSOR switch allows sensor bypass for controller operation regardless of sensor status.
- Three year warranty.

Dimensions

- Width: 7¹/₁₆" (17,9 cm)
- Height: 9¹/₁₆" (24,5 cm)
- Depth: 4¹/₈" (10,5 cm)



Models

- E-3i: 3-station, indoor*
- E-3: 3-station, outdoor*
- E-6i: 6-station, indoor*
- E-6: 6-station, outdoor*
- E-9i: 9-station, indoor*
- E-9: 9-station, outdoor*
- E-12i: 12-station, indoor*
- E-12: 12-station, outdoor*

* Remote ready versions available.

How to Specify

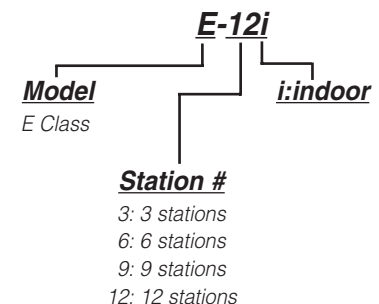



Specifications

The controller shall be of a hybrid type that combines electromechanical and micro-electronic circuitry capable of automatic, semi-automatic, and manual operation. The controller shall be housed in a wall-mountable, plastic cabinet with models for indoor and outdoor installation as well as models that are Remote Control compatible with Rain Bird's RMX-1 multi-function remote control system. Outdoor models shall have a factory-supplied electrical junction box.

The controller shall have _____ stations, each with an operating time range of 0 to 240 minutes in 1-minute increments. The controller shall have a range of repeating, watering day cycles of 1, 2, 3, 4, 5, 6, and 7 days. The controller shall also have a 7-day (weekly) cycle with each day within the cycle adjustable to ON or OFF as a watering day. The controller shall also have a 365-day calendar to provide each program the option of watering only on ODD or EVEN numbered days. The controller shall have an optional ODD day schedule that allows the 31st of any month (and the 29th of February during a leap year) to be a non-water day.

The controller shall have three independent programs which shall be capable of differing watering days, start times, station assignments, and station operating time lengths. The stations shall be assignable to any combination of programs. Each program shall have six (6) start times available per water day. The controller shall be capable of operating one (1) 24 VAC solenoid valve per station plus a master valve or remote pump start relay.

The controller shall have a water budget feature, per program, adjustable in increments of 10% from 0% (Program Off) up

to 200% of the actual time set on the program's stations.

The controller shall have a TEST program to provide one-time, "all-stations" semi-automatic runs adjustable from 1 to 10 minutes for the stations. The TEST program shall skip stations that have zero time settings in the automatic mode and shall not affect the automatic mode time length setting for any station.

The controller shall present the time/date in either the AM/PM, 12-hour mode with the date in the month/day/year format or in the 24-hour mode with the day/month/year format.

The controller shall have an automatic circuit breaker that shall detect a "short circuit" or an electrical overload on any station. The controller shall identify the first "shorted" station and skip it to continue the watering cycle. The controller shall alternately indicate the problem station in the display and the currently operating station.

The controller shall maintain the current time, date and the user's program, without battery, for a minimum of 24 hours without AC power. The controller shall have a default program as a backup for its memory retention system.

The controller shall have a connector to mate to the remote control receiver. The operator shall be able to remotely initialize and advance a manual test program that sequentially runs all stations that have time scheduled in any program for the default run time. The remote operation shall override the controller's rain sensor and off modes.

The controller shall be as manufactured by Rain Bird Sprinkler Mfg. Corp., Glendora, California.

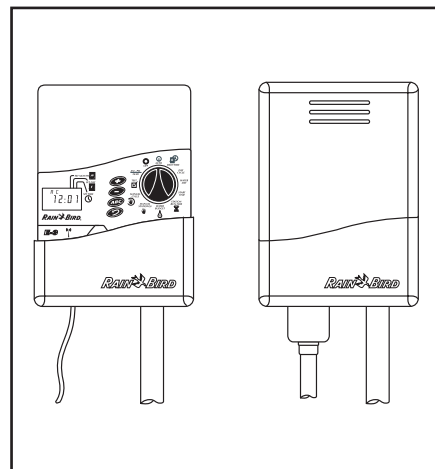

Rain Bird Corporation

Contractor Division

970 West Sierra Madre Avenue, Azusa, CA 91702

Phone: (626) 963-9311 Fax: (626) 812-3411

Rain Bird Corporation

Commercial Division

6991 East Southpoint Road, Tucson, AZ 85706

Phone: (520) 741-6100 Fax: (520) 741-6522

Rain Bird International, Inc.

145 North Grand Avenue, Glendora, CA 91741

Phone: (626) 963-9311 Fax: (626) 963-4287

Rain Bird Technical Service

(800) 247-3782 (U.S. only)

www.rainbird.com

Rain Bird. Conserving More Than Water.

© Registered trademark of Rain Bird Sprinkler Mfg. Corp.

© 2001 Rain Bird Sprinkler Mfg. Corp. 6/01

D39208C